

**Styli for indicators**  
**Taststifte für Messuhren**  
**Stylets pour compareurs**

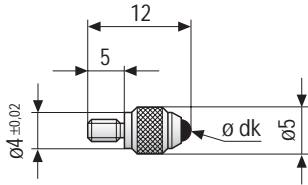

Ø dk	Ball mat. Kugel Mat. Mat. bille	Artikel Nr.
2	RU	43694-9000.00
2	PL	43699-9000.00
3	RU	43694-9001.00
3	PL	43699-9001.00
2	TC	43695-9002.00
3	TC	43695-9003.00

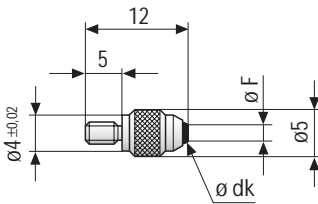

Ø dk	Ø F	Ball mat. Kugel Mat. Mat. bille	Artikel Nr.
2	0.5	RU	43694-9033.00
3	1	RU	43694-9034.00

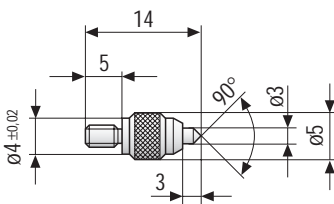

Point mat. Spitze Mat. Mat. pointe	Artikel Nr.
RU	43694-9036.00
TC	43695-9036.00

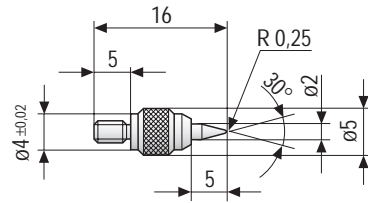

Point mat. Spitze Mat. Mat. pointe	Artikel Nr.
RU	43694-9039.00
TC	43695-9039.00

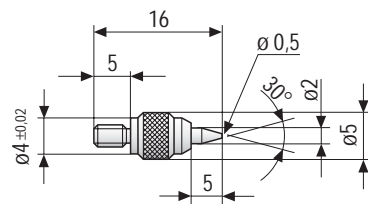

Point mat. Spitze Mat. Mat. pointe	Artikel Nr.
RU	43694-9041.00
TC	43695-9041.00

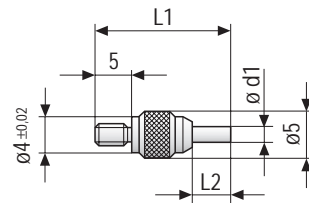

Ø d1	L1	L2	Cylinder mat. Zylinder Mat. Mat. cylindre	Artikel Nr.
1	16	5	RU	43694-9043.00
1	16	5	TC	43695-9043.00
1,5	16	5	RU	43694-9045.00
1,5	16	5	TC	43695-9045.00
2	18	7	RU	43694-9047.00
2	18	7	TC	43695-9047.00
2,5	19	8	RU	43694-9049.00
2,5	19	8	TC	43695-9049.00
3	19	8	RU	43694-9051.00
3	19	8	TC	43695-9051.00

Material description: TC = Tungsten carbide / Hartmetall / Métal dur  
 Werkstoffbeschreibung: RU = Ruby / Rubín / Rubis  
 Désignation matériaux: PL = Plastic / Kunststoff / Plastique